

6 Adapters

6.1 Waveguide to Coaxial Adapter

6.1.1 Waveguide to Coaxial Adapter (Right Angle)

Vector Telecom manufactures Waveguide to Coaxial Adapters covering a full frequency range for Rectangular Waveguides, with multiple flange and coaxial Connector types and configurations available. For more information feel free to call us and discuss your needs with one of our sales engineers.

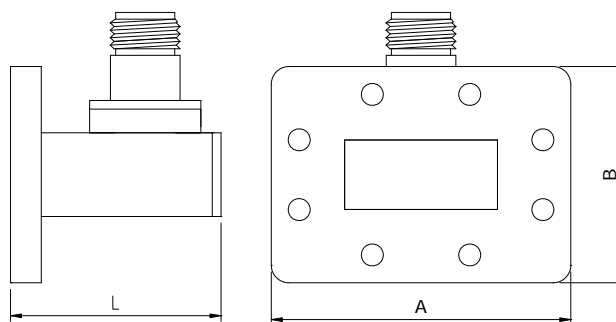

Type N Waveguide to Coaxial Adapters

【Specifications】

Model No*	Freq Range (GHz)	VSWR (Max)	Dimensions L*B*A (mm)	WG Type		Flange	Material
				IEC	EIA		
VT3WCAN...	0.32-0.49	1.25	400*384*676	R3	WR2300	FDP/FDM	Al
VT4WCAN...	0.35-0.53	1.25	380*359*626	R4	WR2100	FDP/FDM	Al
VT5WCAN...	0.41-0.62	1.25	350*318*546	R5	WR1800	FDP/FDM	Al
VT6WCAN...	0.49-0.75	1.25	300*280*470	R6	WR1500	FDP/FDM	Al
VT8WCAN...	0.64-0.98	1.25	260*235*381	R8	WR1150	FDP/FDM	Al
VT9WCAN...	0.75-1.15	1.25	231*212*336	R9	WR975	FDP/FDM	Al
VT12WCAN...	0.96-1.46	1.25	166*187*285	R12	WR770	FDP/FDM	Al
VT14WCAN...	1.13-1.73	1.25	150*138*220	R14	WR650	FDP/FDM	Al
VT18WCAN...	1.45-2.20	1.25	120*120*185	R18	WR510	FDP/FDM	Al/Cu
VT22WCAN...	1.72-2.61	1.25	100*106*161	R22	WR430	FDP/FDM	Al/Cu
VT26WCAN...	2.17-3.30	1.25	90*95*138	R26	WR340	FDP/FDM	Al/Cu
VT32WCAN...	2.60-3.95	1.25	72*76*114	R32	WR284	FDP/FDM	Al/Cu

06

Adapters



VectorTelecomPtyLtd

Website: www.vectortele.com

Email: sales@vectortele.com

Model No*	Freq Range (GHz)	VSWR (Max)	Dimensions L*B*A (mm)	WG Type		Flange	Material
				IEC	EIA		
VT40WCAN...	3.22-4.90	1.25	65*70*98	R40	WR229	FDP/FDM	Al/Cu
VT48WCAN...	3.94-5.99	1.25	54*63*89	R48	WR187	FDP/FDM	Al/Cu
VT58WCAN...	4.64-7.05	1.25	50*62*81	R58	WR159	FDP/FDM	Al/Cu
VT70WCAN...	5.38-8.17	1.25	48*49*68	R70	WR137	FDP/FDM	Al/Cu
VT84WCAN...	6.57-9.99	1.25	40*48*48	R84	WR112	FBP/FBM/FBE	Al/Cu
VT100WCAN...	8.20-12.4	1.25	38*41*41	R100	WR90	FBP/FBM/FBE	Al/Cu
VT120WCAN...	9.84-15.0	1.25	30*38*38	R120	WR75	FBP/FBM/FBE	Al/Cu
VT140WCAN...	11.9-18.0	1.25	27*33*33	R140	WR62	FBP/FBM/FBE	Al/Cu
VT180WCAN...	14.5-22.0	1.25	27*30*30	R180	WR51	FBP/FBM/FBE	Al/Cu

*Indicates Model Number. See Ordering Information for complete part number.

SMA Waveguide to Coaxial Adapters

【Specifications】

Model No*	Freq Range (GHz)	VSWR (Max)	Dimensions L*B*A (mm)	WG Type		Flange	Material
				IEC	EIA		
VT100WCAS...	8.20-12.4	1.25	38*41*41	R100	WR90	FBP/FBM/FBE	Al/Cu
VT120WCAS...	9.84-15.0	1.25	30*38*38	R120	WR75	FBP/FBM/FBE	Al/Cu
VT140WCAS...	11.9-18.0	1.25	27*33*33	R140	WR62	FBP/FBM/FBE	Al/Cu
VT180WCAS...	14.5-22.0	1.25	27*30*30	R180	WR51	FBP/FBM/FBE	Al/Cu
VT220WCAS...	17.6-26.7	1.35	25*22*22	R220	WR42	FBP/FBM/FBE	Al/Cu
VT320WCAS...	26.5-40.0	1.50	25*19*19	R320	WR28	FBP/FBM/FBE	Al/Cu

*Indicates Model Number. See Ordering Information for complete part number.

2.92mm Waveguide to Coaxial Adapters

【Specifications】

Model No*	Freq Range (GHz)	Dimensions L*B*A (mm)	WG Type		Flange	Material
			IEC	EIA		
VT220WCA2.92...	17.6-26.7	33*22*22	R220	WR42	FBP/FBM/FBE	Al/Cu
VT260WCA2.92...	21.7-33.0	27*21*21	R260	WR34	FBP/FBM/FBE	Al/Cu
VT320WCA2.92...	26.5-40.0	25*19*19	R320	WR28	FBP/FBM/FBE	Al/Cu

*Indicates Model Number. See Ordering Information for complete part number.

06

Adapters





2.4mm Waveguide to Coaxial Adapters

【Specifications】

Model No*	Freq Range (GHz)	VSWR (Max)	Dimensions L*B*A (mm)	WG Type		Flange	Material
				IEC	EIA		
VT220WCA2.4...	17.6-26.7	1.50	36*22*22	R220	WR42	FBP/FBM/FBE	Al/Cu
VT260WCA2.4...	21.7-33.0	1.60	27*21*21	R260	WR34	FBP/FBM/FBE	Al/Cu
VT320WCA2.4...	26.5-40.0	1.60	25*19*19	R320	WR28	FBP/FBM/FBE	Al/Cu
VT400WCA2.4...	33.0-50.0	1.60	25*28.6*28.6	R400	WR22	FUGP	Cu

*Indicates Model Number. See Ordering Information for complete part number.

1.85mm Waveguide to Coaxial Adapters

【Specifications】

Model No*	Freq Range (GHz)	VSWR (Max)	Dimensions L*B*A (mm)	WG Type		Flange	Material
				IEC	EIA		
VT500WCA1.85...	40.0-50.0	1.80	25*28.6*28.6	R500	WR19	FUGP	Cu
VT620WCA1.85...	55.0-65.0	1.80	25*19.1*19.1	R620	WR16	FUGP	Cu

*Indicates Model Number. See Ordering Information for complete part number.

1.0mm Waveguide to Coaxial Adapters

【Specifications】

Model No*	Freq Range (GHz)	VSWR (Max)	Dimensions L*B*A (mm)	WG Type		Flange	Material
				IEC	EIA		
VT740WCA1.0...	66.0-86.0	1.80	20*19.1*19.1	R740	WR12	FUGP	Cu
VT900WCA1.0...	90.0-100.0	1.80	25*19.1*19.1	R900	WR10	FUGP	Cu

*Indicates Model Number. See Ordering Information for complete part number.

【Ordering Information】

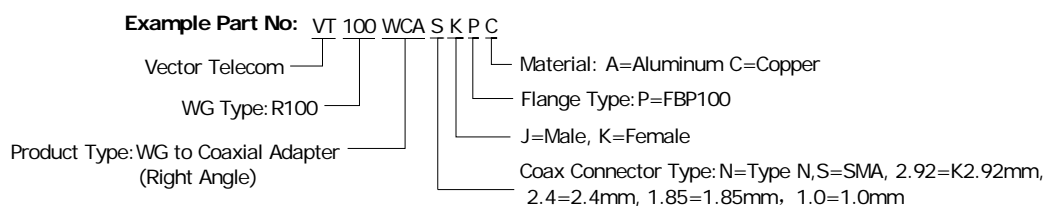

- Flange type: Multiple types available - see VT Flanges page
- Finish: Corrosion protection plus black top coat
- Standard unit provided not sealed pressure tight unless otherwise specified

6.1.2 Waveguide to Coaxial Adapter (End-launch)

Vector Telecom manufactures End-launch Waveguide to Coaxial Adapters covering a full frequency range for Rectangular Waveguides, with multiple flange and coaxial connector types and configuration available. For more information feel free to call us and discuss your needs with one of our sales engineers.

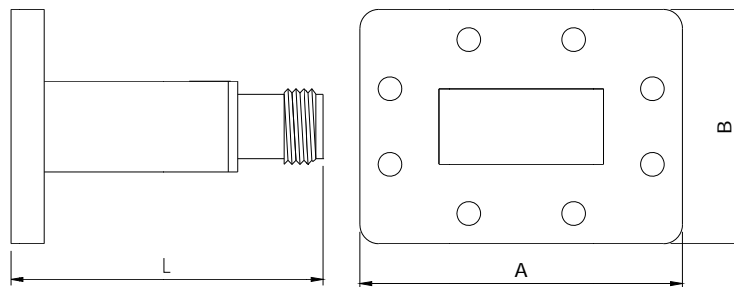
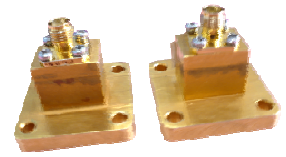

【Specifications】

Model No*	Freq Range (GHz)	VSWR (Max)	Connector Type	Dimensions L*B*A (mm)	WG Type		Flange	Material
					IEC	EIA		
VT22WECAN...	1.72-2.61	1.25	N	128.7*106*161	R22	WR430	FDP/FDM	Al/Cu
VT22WECAS...	1.72-2.61	1.25	SMA	113.4*106*161	R22	WR430	FDP/FDM	Al/Cu
VT26WECAN...	2.17-3.30	1.25	N	118.7*95*138	R26	WR340	FDP/FDM	Al/Cu
VT32WECAN...	2.60-3.95	1.25	N	108.7*76*114	R32	WR284	FDP/FDM	Al/Cu
VT40WECAN...	3.22-4.90	1.25	N	94.7*70*98	R40	WR229	FDP/FDM	Al/Cu
VT48WECAN...	3.94-5.99	1.25	N	74.7*63*89	R48	WR187	FDP/FDM	Al/Cu
VT48WECAS...	3.94-5.99	1.25	SMA	78.4*63*89	R48	WR187	FDP/FDM	Al/Cu
VT58WECAN...	4.64-7.05	1.25	N	72.4*62*81	R58	WR159	FDP/FDM	Al/Cu
VT70WECAN...	5.38-8.17	1.25	N	68.8*49*68	R70	WR137	FDP/FDM	Al/Cu
VT84WECAN...	6.57-9.99	1.25	N	58.8*48*48	R84	WR112	FDP/FBM/FBE	Al/Cu
VT84WECAS...	6.57-9.99	1.25	SMA	49.5*48*48	R84	WR112	FDP/FBM/FBE	Al/Cu
VT100WECAN...	8.20-12.40	1.25	N	49.3*41*41	R100	WR90	FDP/FBM/FBE	Al/Cu
VT100WECAS...	8.20-12.40	1.25	SMA	40*41*41	R100	WR90	FDP/FBM/FBE	Al/Cu
VT120WECAN...	9.84-15.0	1.25	N	46.3*38*38	R120	WR75	FDP/FBM/FBE	Al/Cu
VT120WECAS...	9.84-15.0	1.25	SMA	37*38*38	R120	WR75	FDP/FBM/FBE	Al/Cu
VT140WECAN...	11.9-18.0	1.25	N	43.3*33*33	R140	WR62	FDP/FBM/FBE	Al/Cu
VT140WECAS...	11.9-18.0	1.25	SMA	34*33*33	R140	WR62	FDP/FBM/FBE	Al/Cu
VT180WECAS...	14.5-22.0	1.25	SMA	25*33*33	R180	WR51	FDP/FBM/FBE	Al/Cu

06

Adapters



Vector Telecom Pty Ltd

Website: www.vectortele.com

Email: sales@vectortele.com

Model No*	Freq Range (GHz)	VSWR (Max)	Connector Type	Dimensions L*B*A (mm)	WG Type		Flange	Material
					IEC	EIA		
VT220WECAS...	17.6-26.7	1.35	SMA	17.5*22*22	R220	WR42	FBP/FBM/FBE	Al/Cu
VT220WECAK...	17.6-26.7	1.50	V2.4mm	18*22*22	R220	WR42	FBP/FBM/FBE	Al/Cu
VT220WECAV...	17.6-26.7	1.50	K2.92mm	18*22*22	R220	WR42	FBP/FBM/FBE	Al/Cu
VT260WECAK...	21.7-33.0	1.50	K2.92mm	21*21*21	R260	WR34	FBP/FBM/FBE	Al/Cu
VT260WECAV...	21.7-33.0	1.50	V2.4mm	21*21*21	R260	WR34	FBP/FBM/FBE	Al/Cu
VT320WECAK...	26.3-40.0	1.50	SMA	16*19*19	R320	WR28	FBP/FBM/FBE	Al/Cu
VT320WECAV...	26.3-40.0	1.50	V2.4mm	16.5*19*19	R320	WR28	FBP/FBM/FBE	Al/Cu
VT400WECAV	33.0-50.0	1.50	V2.4mm	8.8*28.6*28.6	R400	WR22	FUGP	Cu
VT500WECAV	40.0-50.0	1.6	V2.4mm	7*28.6*28.6	R500	WR19	FUGP	Cu
VT500WECA1.85	40.0-50.0	1.6	1.85mm	7*28.6*28.6	R500	WR19	FUGP	Cu
VT620WECA1.85	55.0-65.0	1.6	1.85mm	7*19.1*19.1	R620	WR15	FUGP	Cu
VT740WECA1.0	66.0-86.0	1.8	1.0mm	6*19.1*19.1	R740	WR12	FUGP	Cu
VT900WECA1.0	90.0-100.0	1.8	1.0mm	6*19.1*19.1	R900	WR10	FUGP	Cu

*Indicates Model Number. See Ordering Information for complete part number.

【Ordering Information】

Example Part No: VT 100 WECA S K P C

Vector Telecom —
WG Type: R100 —
Product Type: WG To Coaxial Adapter (End-launch) —

Material: A=Aluminum, C=Copper
Flange Type: P=FBP100
J=Male, K=Female
Coax Connector Type: N=Type N, S=SMA,
2.92 =K 2.92mm, 2.4=2.4mm, 1.85=1.85mm, 1.0=1.0mm

- Flange type: Multiple types available - see VT Flanges page
- Finish: Corrosion protection plus black top coat
- Standard unit provided not sealed pressure tight unless otherwise specified

6.1.3 High Power Waveguide to Coaxial Adapter

Vector Telecom manufactures High Power Waveguide to Coaxial Adapters up to 5kW for Rectangular Waveguides, with multiple flange and coaxial connector types and configurations available. For more information feel free to call us and discuss your needs with one of our sales engineers.

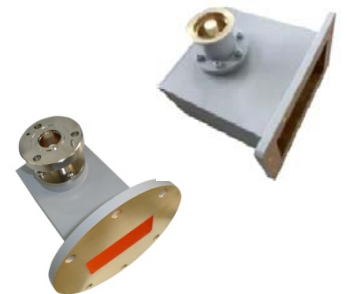

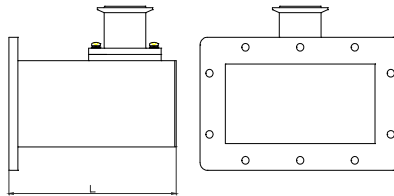

【Specifications】

Model No*	Freq Range (GHz)	VSWR (Max)	Working Bandwidth	WG Type		IL (dB)	Connector	Avg Power (W)	Flange	Material
				IEC	EIA					
VT14WHPCA...	1.13-1.73	1.15	≤15%	R14	WR650	≤0.2	1'5/8 Female	≤5000	FDP	Al
VT14WHPCA...	1.13-1.73	1.15	≤15%	R14	WR650	≤0.2	5339 Female	≤5000	FDP	Al
VT14WHPCAL...	1.13-1.73	1.15	≤15%	R14	WR650	≤0.2	L29 Female	≤2000	FDP	Al
VT14WHPCAL...	1.13-1.73	1.15	≤15%	R14	WR650	≤0.2	L27 Female	≤2000	FDP	Al
VT18WHPCA...	1.45-2.2	1.15	≤15%	R18	WR510	≤0.2	1'5/8 Female	≤4000	FDP	Al
VT18WHPCA...	1.45-2.2	1.15	≤15%	R18	WR510	≤0.2	5339 Female	≤4000	FDP	Al
VT18WHPCAL...	1.45-2.2	1.15	≤15%	R18	WR510	≤0.2	L27 Female	≤2000	FDP	Al
VT22WHPCA...	1.72-2.61	1.15	≤15%	R22	WR430	≤0.2	1'5/8 Female	≤3000	FDP	Al
VT22WHPCA...	1.76-2.61	1.15	≤15%	R22	WR430	≤0.2	5339 Female	≤3000	FDP	Al
VT22WHPCAL...	1.72-2.61	1.15	≤15%	R22	WR430	≤0.2	L29 Female	≤2000	FDP	Al
VT22WHPCAL...	1.72-2.61	1.15	≤15%	R22	WR430	≤0.2	L27 Female	≤2000	FDP	Al
VT26WHPCAL...	2.17-3.30	1.15	≤15%	R26	WR340	≤0.2	L29 Female	≤2000	FDP	Al
VT26WHPCAL...	2.17-3.3	1.15	≤15%	R26	WR340	≤0.2	L27 Female	≤2000	FDP	Al
VT32WHPCAL...	2.60-3.95	1.15	≤15%	R32	WR284	≤0.2	L29 Female	≤1000	FDP	Al
VT32WHPCAL...	2.60-3.95	1.15	≤15%	R32	WR284	≤0.2	L27 Female	≤1000	FDP	Al
VT40WHPCAL...	3.22-4.90	1.15	≤15%	R40	WR229	≤0.2	L29 Female	≤1000	FDP	Al
VT40WHPCAL...	3.22-4.90	1.15	≤15%	R40	WR229	≤0.2	L27 Female	≤1000	FDP	Al
VT40WHPCAN...	3.22-4.90	1.25	≤15%	R40	WR229	≤0.2	N Female	≤200	FDP	Al
VT48WHPCAL...	3.94-5.99	1.15	≤15%	R48	WR187	≤0.2	L29 Female	≤1000	FDP	Al
VT48WHPCAL...	3.94-5.99	1.15	≤15%	R48	WR187	≤0.2	L27 Female	≤1000	FDP	Al
VT48WHPCAN...	3.94-5.99	1.25	≤15%	R48	WR187	≤0.2	N Female	≤200	FDP	Al
VT58WHPCAN...	4.64-7.05	1.25	≤15%	R58	WR159	≤0.2	N Female	≤200	FDP	Al
VT70WHPCAN...	5.38-8.17	1.25	≤15%	R70	WR137	≤0.3	N Female	≤200	FDP	Al
VT84WHPCAN...	6.57-9.99	1.25	≤15%	R84	WR112	≤0.3	N Female	≤200	FDP	Cu
VT100WHPCAN...	8.20-12.4	1.25	≤15%	R100	WR90	≤0.3	N Female	≤200	FDP	Cu
VT120WHPCAN...	9.84-15.0	1.25	≤15%	R120	WR75	≤0.3	N Female	≤200	FDP	Cu
VT140WHPCAN...	11.9-18.0	1.15	≤15%	R140	WR62	≤0.3	N Female	≤200	FDP	Cu

*Indicates Model Number. See Ordering Information for complete part number.

【Ordering Information】

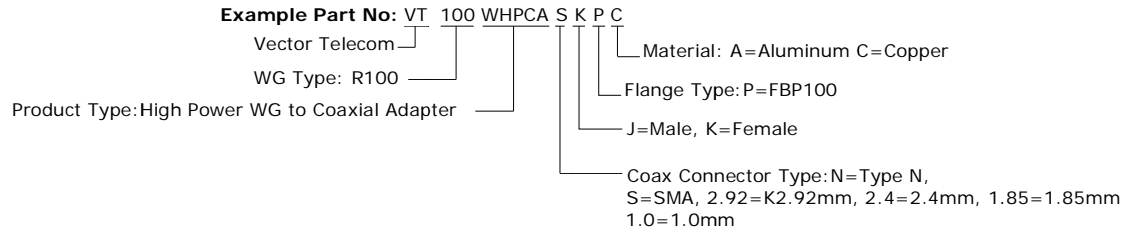

- Flange type: Multiple types available - see VT Flanges page
- Finish: Corrosion protection plus black top coat
- Standard unit provided not sealed pressure tight unless otherwise specified

6.2 Double Ridged Waveguide to Coaxial Adapter

Vector Telecom manufactures Waveguide to Coaxial Adapters covering a full frequency range for Double-Ridged Waveguides, with multiple flange and coaxial connector types and configurations available. For more information feel free to call us and discuss your needs with one of our sales engineers.

6.2.1 Double Ridged Waveguide To Coaxial Adapter (Right Angle)

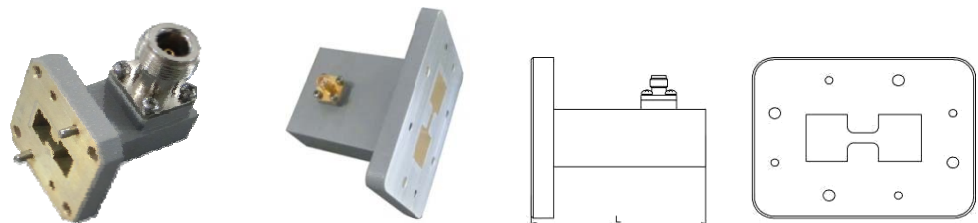

【Specifications】

Model No*	Freq Range (GHz)	VSWR (Max)	Length L(mm)	WG Type EIA	IL (dB)	Connector	Avg Power (W)	Flange	Material
VT84DRWCAN...	0.84-2	1.50	175	WRD84	≤0.5	N Female	800	FP	Al
VT150DRWCAN...	1.5-3.6	1.50	150	WRD150	≤0.5	N Female	800	FP	Al
VT200DRWCAN...	2-4.8	1.50	101	WRD200	≤0.5	N Female	500	FP	Al
VT250DRWCAN...	2.6-7.8	1.50	70	WRD250	≤0.5	N Female	500	FP	Al
VT350DRWCAN...	3.5-8.2	1.50	60	WRD350	≤0.5	N Female	500	FP	Al
VT475DRWCAN...	4.75-11	1.50	50	WRD475	≤0.5	N Female	300	FP	Al
VT500DRWCAS...	5-18	1.50	45	WRD500	≤0.5	SMA Female	300	FP	Al
VT580DRWCAS...	5.8-16	1.50	45	WRD580	≤0.5	SMA Female	300	FP	Al
VT650DRWCAS...	6.5-18	1.50	45	WRD650	≤0.5	SMA Female	100	FP	Cu

Model No*	Freq Range (GHz)	VSWR (Max)	Length L(mm)	WG Type EIA	IL (dB)	Connector	Avg Power (W)	Flange	Material
VT750DRWCAS...	7.5-18	1.50	40	WRD750	≤0.5	SMA Female	100	FP	Cu
VT700DRWCAS...	7-18.5	1.50	40	WRD700	≤0.5	SMAFemale	100	FP	Cu
VT1100DRWCAK..	11-26.5	1.50	35	WRD1100	≤0.5	2.92 Female	50	FP	Cu
VT1800DRWCAK..	18-40	2.00	27	WRD1800	≤0.5	2.92 Female	50	FP	Cu

*Indicates Model Number. See Ordering Information for complete part number.

6.2.2 Double Ridged Waveguide to Coaxial Adapter (End Launch)

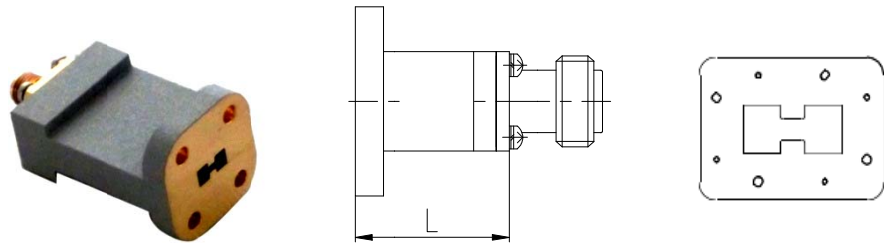

【Specifications】

Model No*	Freq Range (GHz)	VSWR (Max)	Length L(mm)	WG Type EIA	IL (dB)	Connector	Avg Power (W)	Flange	Material
VT84DRWECAN...	0.84-2	1.50	300	WRD84	≤0.5	N Female	800	FP	Al
VT150DRWECAN	1.5-3.6	1.50	160	WRD150	≤0.5	N Female	800	FP	Al
VT200DRWECAN	2-4.8	1.50	120	WRD200	≤0.5	N Female	500	FP	Al
VT250DRWECAN	2.6-7.8	1.50	85	WRD250	≤0.5	N Female	500	FP	Al
VT350DRWECAN	3.5-8.2	1.50	80	WRD350	≤0.5	N Female	500	FP	Al
VT475DRWECAN	4.75-11	1.50	50	WRD475	≤0.5	N Female	300	FP	Al
VT500DRWECAS	5-18	1.50	45	WRD500	≤0.5	SMA Female	300	FP	Al
VT580DRWECAS	5.8-16	1.50	40	WRD580	≤0.5	SMA Female	300	FP	Al
VT650DRWECAS	6.5-18	1.50	33.7	WRD650	≤0.5	SMA Female	100	FP	Cu
VT750DRWECAS	7.5-18	1.50	33.7	WRD750	≤0.5	SMA Female	100	FP	Cu
VT700DRWECAS	7-18.5	1.50	33	WRD700	≤0.5	SMA Female	50	FP	Cu
VT1100DRWECK	11-26.5	1.50	30	WRD110	≤0.5	2.92Female	30	FP	Cu
VT1800DRWECK	18-40	2.00	36.8	WRD180	≤0.8	2.92Female	30	FP	Cu

*Indicates Model Number. See Ordering Information for complete part number.

06

Adapters





6.2.3 Double Ridged High Power Waveguide to Coaxial Adapter

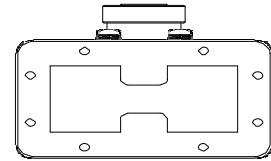
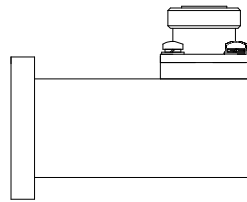

【Specifications】

Model No*	Freq Range (GHz)	VSWR (Max)	WG Type EIA	IL (dB)	Connector	Avg Power (W)	Flange	Material
VT84DRWHPCA...	0.84-2	1.50	WRD84	≤0.5	5339Female	1000	FP	Al
VT84DRWHPCAL...	0.84-2	1.50	WRD84	≤0.5	L29Female	500	FP	Al
VT84DRWHPCAL...	0.84-2	1.50	WRD84	≤0.5	L27Female	500	FP	Al
VT84DRWHPCAN...	0.84-2	1.50	WRD84	≤0.5	N Female	300	FP	Al
VT150DRWHPCAN...	1.5-3.6	1.50	WRD150	≤0.5	N Female	300	FP	Al
VT200DRWHPCAN...	2-4.8	1.50	WRD200	≤0.5	N Female	300	FP	Al
VT250DRWHPCAN...	2.6-7.8	1.50	WRD250	≤0.5	N Female	300	FP	Al
VT350DRWHPCAN...	3.5-8.2	1.50	WRD350	≤0.5	N Female	200	FP	Al
VT475DRWHPCAN...	4.75-11	1.50	WRD475	≤0.5	N Female	200	FP	Al
VT500DRWHPCAN...	5-18	1.50	WRD500	≤0.5	N Female	200	FP	Al
VT580DRWHPCAN...	5.8-16	1.50	WRD580	≤0.5	N Female	200	FP	Al
VT650DRWHPCAN...	6.5-18	1.50	WRD650	≤0.5	N Female	200	FP	Cu
VT750DRWHPCAN...	7.5-18	1.50	WRD750	≤0.8	N Female	200	FP	Cu

*Indicates Model Number. See Ordering Information for complete part number.

【Ordering Information】

Example Part No: VT 650 DRWCA S K P C

Vector Telecom — VT
 WG Type: WRD650 — 650
 Product Type: Double WG to Coaxial Adapter (Right Angle) — DRWCA
 Material: A=Aluminum C=Copper — C
 Flange Type: P=FBP100 — P
 J=Male, K=Female — K
 Coax Connector Type: N=Type N, S=SMA 2.92=K2.92mm, 2.4=2.4mm, L29=7/16 — S

Code	Description
DRWCA	Double Ridged Waveguide to Coaxial Adapter (Right Angle)
DRWECA	Double Ridged Waveguide to Coaxial Adapter (End-launch)
DRWHPCA	Double Ridged High Power Waveguide to Coaxial Adapter

- Flange type: Multiple types available - see VT Flanges page
- Finish: Corrosion protection plus black top coat



6.3 Circular Waveguide to Coaxial Adapter



【Ordering Information】

Model No*	Freq Range (GHz)	VSWR (Max)	Working Bandwidth	Inner Diameter Φ (mm)	Connector
VT114.58CWCAN...	1.76-2.42	1.25	$\leq 20\%$	≤ 0.5	N Female
VT97.87CWCAN...	2.1-2.8	1.25	$\leq 20\%$	≤ 0.5	N Female
VT83.62CWCAN...	2.45-3.3	1.25	$\leq 20\%$	≤ 0.5	N Female
VT71.42CWCAN...	2.83-3.88	1.25	$\leq 20\%$	≤ 0.5	N Female
VT51.99CWCAN...	3.9-5.3	1.25	$\leq 20\%$	≤ 0.5	N Female
VT44.45CWCAN...	4.55-6.23	1.25	$\leq 20\%$	≤ 0.8	N Female
VT38.1CWCAN...	5.3-7.3	1.25	$\leq 20\%$	38.1	N Female
VT32.537CWCAN...	6.3-8.5	1.25	$\leq 20\%$	32.537	N Female
VT27.788CWCAN...	7.3-9.5	1.25	$\leq 20\%$	27.788	N Female
VT23.825CWCAN...	8.5-11.5	1.25	$\leq 20\%$	23.825	N Female
VT17.415CWCAS...	11.6-15.9	1.25	$\leq 20\%$	17.415	SMA Female
VT15.088CWCAS...	13.4-18.4	1.25	$\leq 20\%$	15.088	SMA Female
VT12.7CWCAS...	15.9-21.8	1.25	$\leq 20\%$	12.7	SMA Female
VT9.525CWCAK...	21.2-29.1	1.25	$\leq 20\%$	9.525	2.92 Female
VT8.331CWCAK...	24.3-33.2	1.30	$\leq 15\%$	8.331	2.92 Female
VT7.137CWCAK...	28.3-38.8	1.30	$\leq 15\%$	7.137	2.92 Female

*Indicates Model Number. See Ordering Information for complete part number.

【Ordering Information】

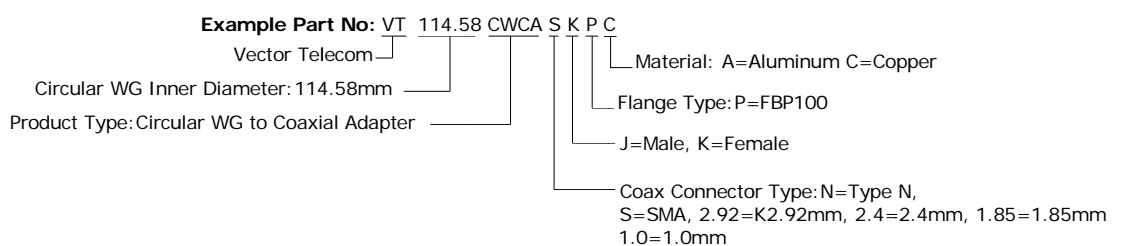

- Flange type: Multiple types available - see VT Flanges page
- Finish: Corrosion protection plus black top coat
- Standard unit provided not sealed pressure tight unless otherwise specified.



6.4 Waveguide to Microstrip Adapter

6.4.1 Waveguide to Microstrip Adapter (Right Angle)

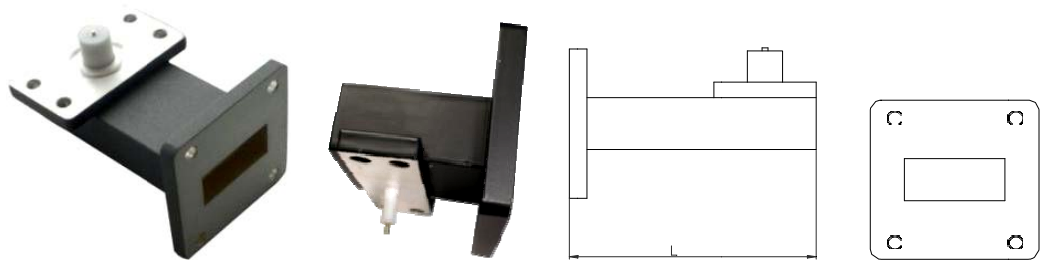

【Specifications】

Model No*	WG Type EIA	Freq Range (GHz)	Working Bandwidth	VSWR (Max)	IL (dB)	Avg Power (W)	Length L (mm)	Flange	Material
VT32WMI	WR284	2.60-3.95	≤15%	1.25	≤0.2	100	80	FDP	Al
VT40WMI	WR229	3.22-4.90	≤15%	1.25	≤0.2	100	70	FDP	Al
VT48WMI	WR187	3.94-5.99	≤15%	1.25	≤0.2	100	70	FDP	Al
VT58WMI	WR159	4.64-7.05	≤15%	1.25	≤0.2	100	60	FDP	Al
VT70WMI	WR137	5.38-8.17	≤15%	1.25	≤0.2	100	50	FDP	Cu
VT84WMI	WR112	6.57-9.99	≤15%	1.25	≤0.2	50	45	FBP	Cu
VT100WMI	WR90	8.20-12.40	≤15%	1.25	≤0.2	50	50	FBP	Cu
VT120WMI	WR75	9.84-15.0	≤15%	1.25	≤0.2	50	40	FBP	Cu
VT140WMI	WR62	11.9-18.0	≤15%	1.25	≤0.2	50	40	FBP	Cu
VT180WMI	WR51	14.5-22.0	≤15%	1.25	≤0.2	50	35	FBP	Cu
VT220WMI	WR42	17.6-26.7	≤15%	1.50	≤0.3	30	30	FBP	Cu
VT260WMI	WR34	21.7-33.0	≤15%	1.50	≤0.5	30	26	FBP	Cu
VT320WMI	WR28	26.5-40.0	≤15%	1.50	≤0.5	30	26	FBP	Cu

*Indicates Model Number. See Ordering Information for complete part number.

6.4.2 Waveguide to Microstrip Adapter (End Launch)

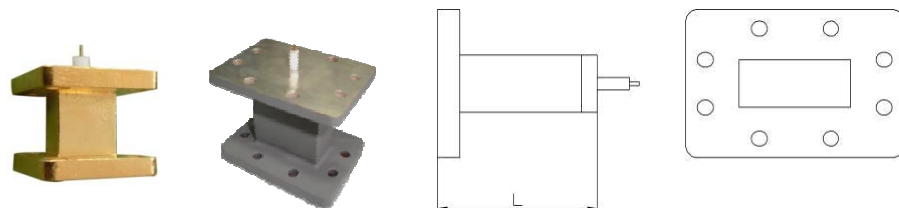

【Specifications】

Model No*	WG Type EIA	Freq Range (GHz)	VSWR (Max)	IL(dB)	Avg Power (W)	Length L(mm)	Flange	Material
VT32WEMI	WR284	2.60-3.95	1.25	≤0.2	100	82	FDP	Al
VT40WEMI	WR229	3.22-4.90	1.25	≤0.2	100	68	FDP	Al

Model No*	WG Type EIA	Freq Range (GHz)	VSWR (Max)	IL(dB)	Avg Power (W)	Length L(mm)	Flange	Material
VT48WEMI	WR187	3.94-5.99	1.25	≤0.2	100	58	FDP	Al
VT58WEMI	WR159	4.64-7.05	1.25	≤0.2	100	56	FDP	Al
VT70WEMI	WR137	5.38-8.17	1.25	≤0.2	100	50	FDP	Cu
VT84WEMI	WR112	6.57-9.99	1.25	≤0.2	50	40	FBP	Cu
VT100WEMI	WR90	8.20-12.40	1.25	≤0.2	50	30.5	FBP	Cu
VT120WEMI	WR75	9.84-15.0	1.25	≤0.2	50	21	FBP	Cu
VT140WEMI	WR62	11.9-18.0	1.25	≤0.2	50	24	FBP	Cu
VT180WEMI	WR51	14.5-22.0	1.25	≤0.2	50	25	FBP	Cu
VT220WEMI	WR42	17.6-26.7	1.50	≤0.3	30	18	FBP	Cu
VT260WEMI	WR34	21.7-33.0	1.50	≤0.5	30	21	FBP	Cu
VT320WEMI	WR28	26.5-40.0	1.50	≤0.5	30	16	FBP	Cu

*Indicates Model Number. See Ordering Information for complete part number.

【Ordering Information】

Example Part No: VT 32 WMI

Vector Telecom ————
 WG Type:R32 ————
 Product Type: WMI: WG to Microstrip Adapter (Right Angle)
 WEMI: WG to Microstrip Adapter (End Launch)

- Flange type: Multiple types available - see VT Flanges page
- Finish: Corrosion protection plus black top coat

06

Adapters



VectorTelecomPtyLtd

Website: www.vectortele.com

Email: sales@vectortele.com